

SEZ. A-A

SEZ. B-B

WARNING
 THE SHAFT MEASUREMENTS
 AND DOORS POSITION
 ARE VERY IMPORTANT.
 THE ADMITTED TOLERANCE IS
 IS 5 mm ONLY.

THE RAIL FASTENINGS
 MUST BE WALLED BY
 KEEPING THE OPENING
 ON THE WALL LIDE

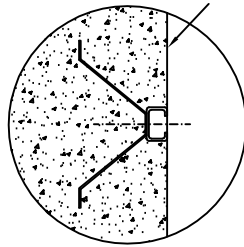
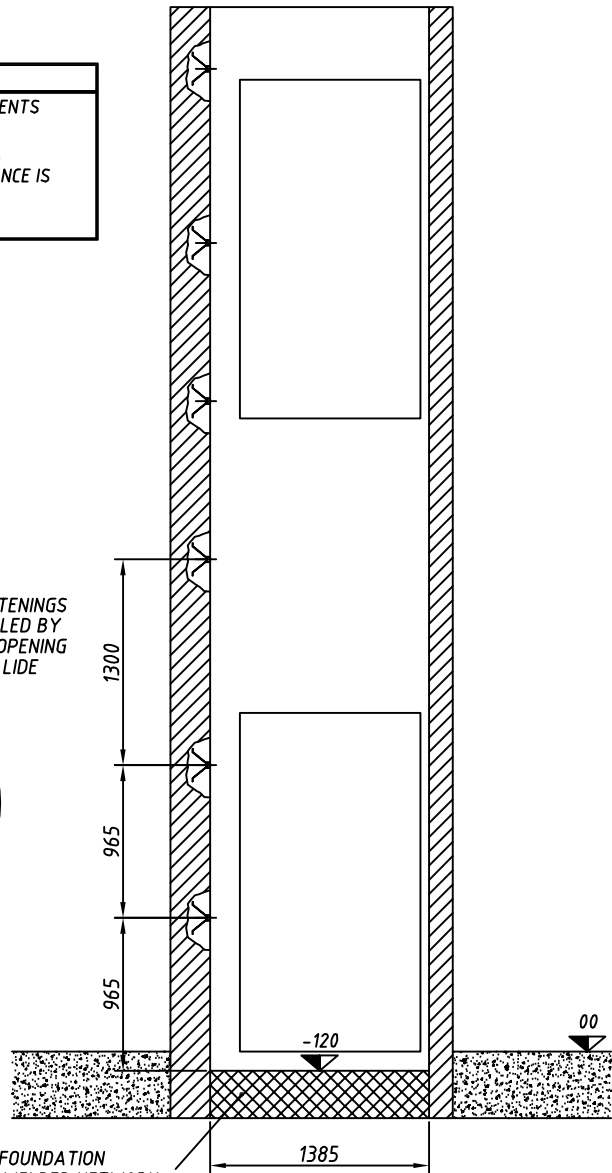
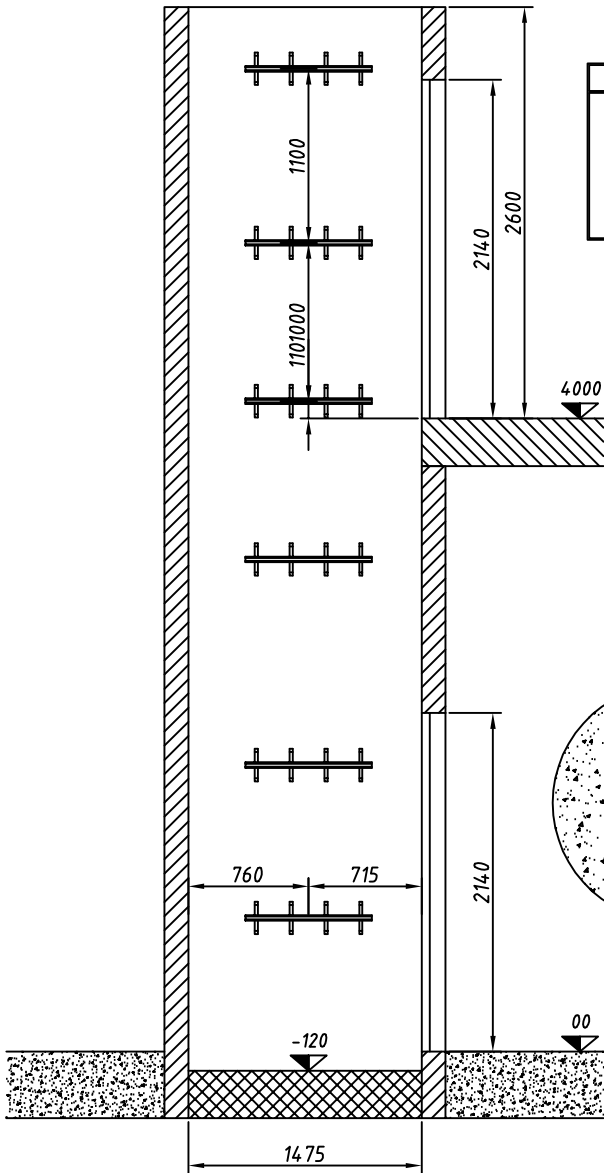

CONCRETE FOUNDATION
 WITH ELECTRIC-WELDED NETWORK

ORDER :	146748	DATA RICEZIONE DISEGNO	-----
CUSTOMER :	ORTO PLUS LIFTS KACZMARCZYK HU	STAMP AND SIGNATURE FOR ACCEPTANCE	
FINAL USER :		-----	
RIF. :	-		
MODEL :	E07		

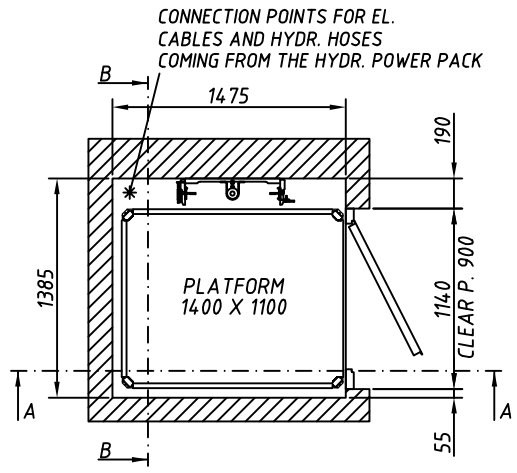

TOP VIEW GROUND FLOOR
 TOP VIEW FLOOR 1

- BUILD WALL ENCLOSURE WITH INTERNAL FREE DIMENSIONS THE WALL MUST BE PERFECTLY IN SQUARE AND VERTICAL; THE DOOR OPENINGS TO BE ROUGH AND THE FINISHING AFTER THE DOORS INSTALLATION.
- THE RAIL FASTENINGS TO BE CAREFULL WALLED AT THE GIVEN DISTANCES AND PERFECTLY VERTICAL.
- THE REVEAL MUST BE LEFT UNFINISHED. THE FINISHING TO BE MADE AFTER HAVING WALLED THE DOORS.
- SET RACEWAYS $\phi 32$ mm. DIAM. FOR THE LOCK EL. CABLES. THEY MUST CONNECT DOOR FOOTING LOCK SIDE WITH HYDRAULIC HOSES AND EL. CABLES ASSEMBLY AREA.
- ATTENTION: BEFORE INSTALLING, CHECHE THE POSSIBILIT OF INSERTING THE CYLINDER IN THE WALLED TRAVEL OPENING..... CYLINDER= 2800 mm
- SHAFT DOOR TO BE BUILT SO AS THE WALLS ADJACENT TO THE PLATFORM HAVE NOT OUTRIGGERS AND REENTRANCES OVER 2 mm.
- POSITION TWO BEAMS AS INDICATED IN THE DRAWING CALCULATE THE KIND OF BEAM AND THE ANCORAGE AS PER THE ENCLOSED LOADING DIAGRAM